

MENOMINEE COUNTY ZONING PERMIT REQUEST FOR IMPERVIOUS SURFACES, FILL, OR GRADING

Updated 01/2018

Owners Name: _____ Phone Number: _____

Address: _____

Legal Description: _____

Tax Parcel #: _____

Contractor's Name: _____ Phone Number: _____

Zoning Request: _____

Reason: _____

Estimated project cost: \$ _____

Date: _____ Signature: _____

- * Required attachments: Plot plan(s) with current impervious surfaces and proposed additions of impervious surfaces coverage. Include all square footages of existing and proposed surfaces. See next page for completing calculations.
- * For fill, excavating, or grading within 300 feet of surface waters: Indicate the slope of the specific area and the amount of area being disturbed and/or filled.

ZONING DEPARTMENT

Decision: _____ Granted _____ Granted on condition of _____

Denied because _____

Zoning Administrator: _____ Date: _____

Fee: **\$ 75.00**

Permit #: _____

** Permit valid one year from date of issuance*

Menominee County Impervious Surface Calculations and Site Plan Example

Impervious Surface Type	Dimensions (ft)	Surface Area
House	X	sq ft
Garage	X	sq ft
Shed	X	sq ft
Lean-to	X	sq ft
Open Deck/Porch	X	sq ft
Fire-pit	X	sq ft
Driveway	X	sq ft
Sidewalk	X	sq ft
Other	X	sq ft
Total Impervious Surface Estimate		sq ft

Please Note:

- Building dimensions must include overhangs.
- Impervious Surfaces: Any surface that causes the water to roll off.
- Exemptions: stairs, mitigated buildings, reinvented permeable pavers
- All properties and buildings within 300 feet of navigable waterways must abide by these standards.
- Lot coverage over 15% requires a Mitigation Affidavit and there is a 30% upper limit.

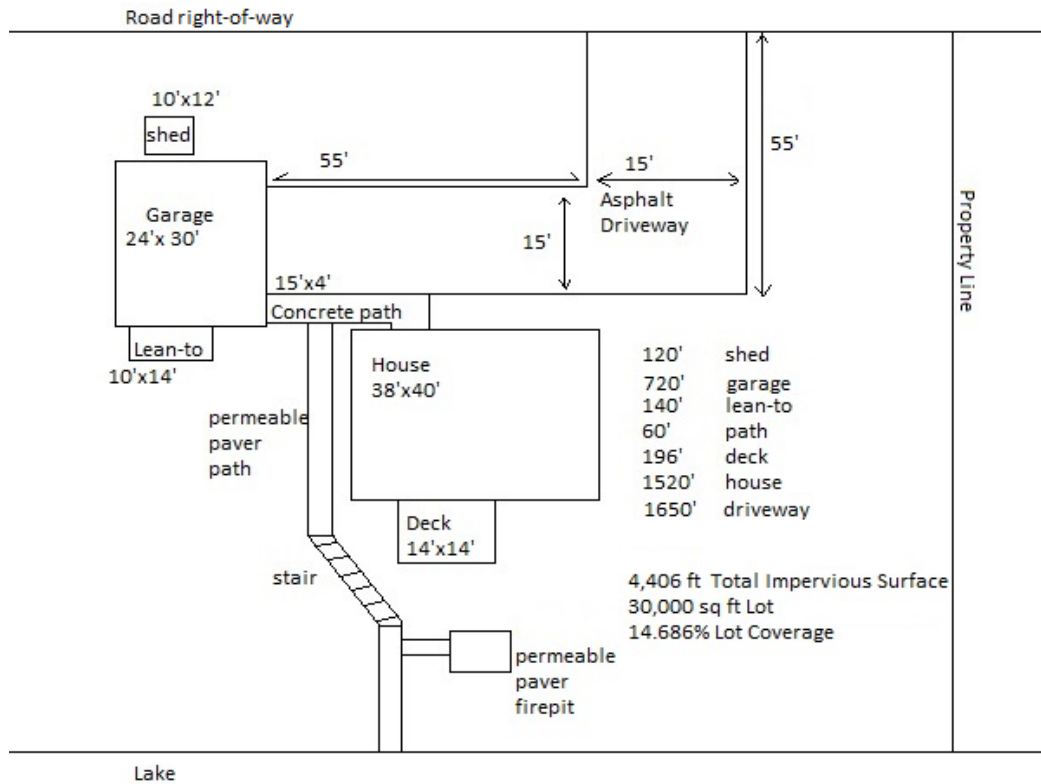

*Include your sketch on the back of this form

**TOWN OF MENOMINEE /
MENOMINEE COUNTY
DISCLAIMER OF LIABILITY:**

By issuing this permit, Menominee County does not take responsibility for any development or construction undertaken pursuant to the permit, and Menominee County expressly disclaims any responsibility or liability for such development or construction. The permit holder, by undertaking any such development or construction, does so based solely upon their own judgment and not upon any representations of any agent or employee of Menominee County, whether expressed or implied. The permit holder releases Menominee County and indemnifies it from any and all claims for damages or otherwise resulting from any development or construction carried on pursuant to this permit.

Signature

Date